

## Adaptadores para conexiones de mangueras

### Manguito Para Soldar Rosca BSPP JIC

**D0519**

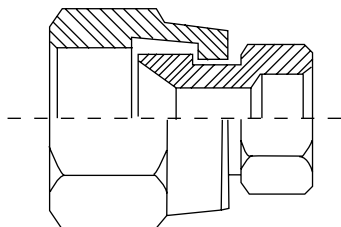

Material Hierro Zincado

Nº CODIGO	Ø Tubo Exterior	Ø de Rosca BSPP
02-00	1/8"	1/8"-28
04-00	1/4"	1/4"-19
06-00	3/8"	3/8"-19
08-00	1/2"	1/2"-14
10-00	5/8"	5/8"-14
12-00	3/4"	3/4"-14
16-00	1"	1"-11
20-00	1 1/4"	1 1/4"-11
24-00	1 1/2"	1 1/2"-11
32-00	2"	2"-11

### Codo 90 Rosca Macho BSPP AS JIC 37 a Rosca Macho BSPT

**D0520**

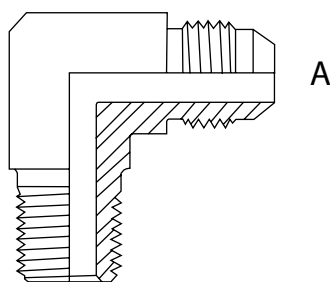

Material Hierro Zincado

Nº CODIGO	Ø Exterior Tubo	Ø de Rosca BSPP JIC (A)	Ø de Rosca BSPT (B)
02-02	1/8"	1/8"-28	1/8"-28
04-04	1/4"	1/4"-19	1/4"-19
06-06	3/8"	3/8"-19	3/8"-19
08-08	1/2"	1/2"-14	1/2"-14
10-10	5/8"	5/8"-14	5/8"-14
12-12	3/4"	3/4"-14	3/4"-14
16-16	1"	1"-11	1"-11
20-20	1 1/4"	1 1/4"-11	1 1/4"-11
24-24	1 1/2"	1 1/2"-11	1 1/2"-11
32-32	2"	2"-11	2"-11

### Adaptador Macho BSPP As.JIC a Ciego

**D0521**

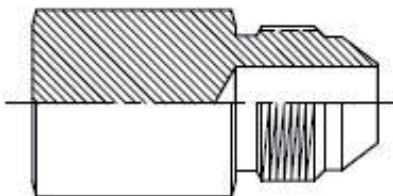

Material Hierro Zincado

Nº CODIGO	Ø Rosca BSPP
02-00	1/8"-28h
04-00	1/4"-19h
06-00	3/8"19h
08-00	1/2"-14h
12-00	3/4"14h
16-00	1"-11h
20-00	1 1/4"-11h
24-00	1 1/2"-11h
32-00	2"-11h